

42U, 23 in. EIA Mounting Rails for 750 mm Wide NetShelter™ SX Cabinets

AR7510

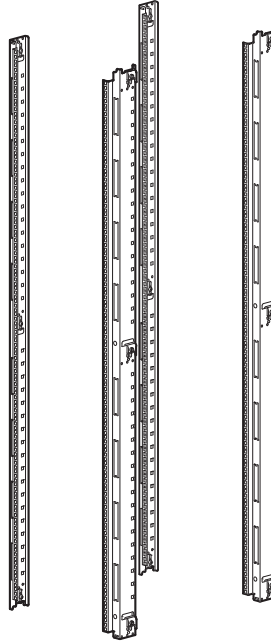

Mounting Rail Set (1)

Preparation

1. Use the Torx® T30/Phillips #2 wrench (provided with your cabinet) to loosen the Torx screws in each of the vertical mounting flanges to be replaced.
2. Unlock the mounting flanges.
3. Remove the vertical mounting flanges that were provided with the NetShelter SX cabinet.

NOTE: All vertical mounting flanges remove from the cabinet by the same procedure.

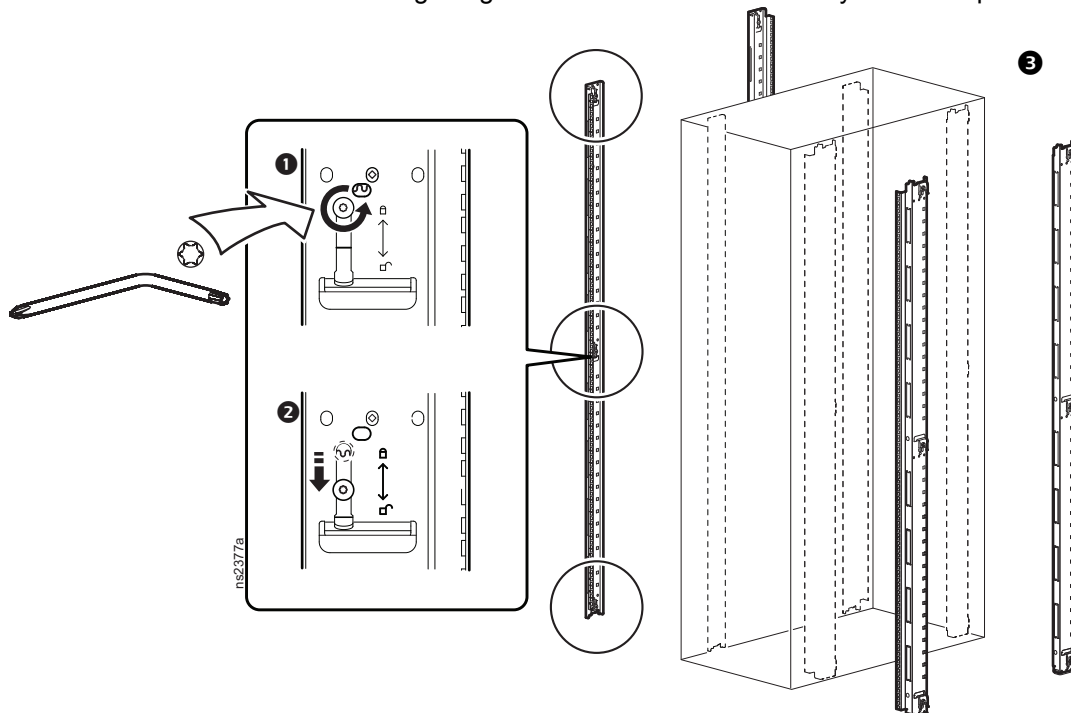

Installation

1. Place the 23 in. Electronic Industries Alliance (EIA) vertical mounting rail onto the enclosure side brace.

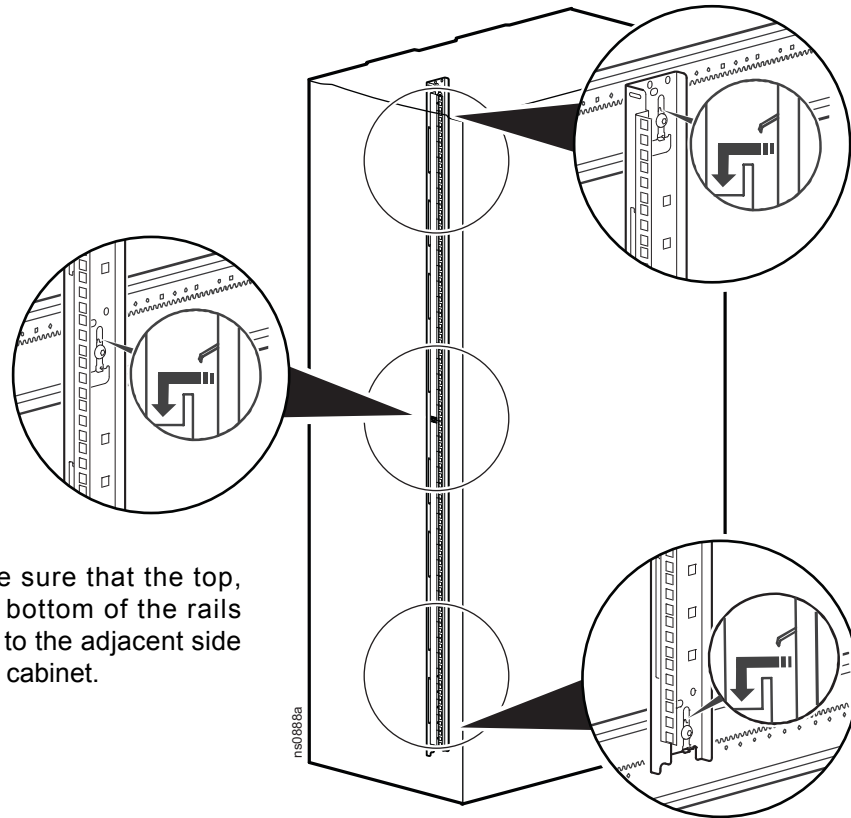

NOTE: Make sure that the top, middle, and bottom of the rails are attached to the adjacent side braces of the cabinet.

2. When the EIA vertical mounting rail is in the proper location, slide the locking screw up, until the teeth in the bracket engage fully with the teeth in the side brace.

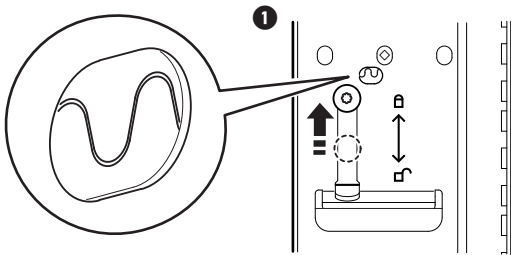

3. Using the Torx T30/Phillips #2 wrench, tighten the screw.

NOTE: See "Vertical Mounting Flange Adjustment" in the "Equipment Installation" section of the NetShelter SX Cabinet Installation, and Customization manual for more information.

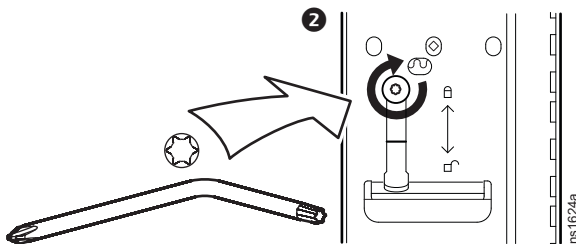

4. Repeat for all flanges to be replaced within the cabinet.